



BeyonSense Tutorial.

Content

Contents	1
How to Use BeyonSense® Device	2
1. Getting Started	2
♦ Charge	2
♦ Power.....	2
♦ Replace lens	2
How to Use BeyonSense®Pre App (iOS & Android)	2
1. Install App	3
2. Wi-Fi connection	3
3. Launch App	3
4. UI Description	4
① Lens mode	4
② Calibration.....	4
③ Brightness.....	5
④ Screen mode.....	5
⑤ Album	5
⑥ Shutter	6
⑦ Settings	6



How to Use BeyonSense[®] Device

1. Getting Started

◆ Charge

Fully charge your BeyonSense device prior to use.

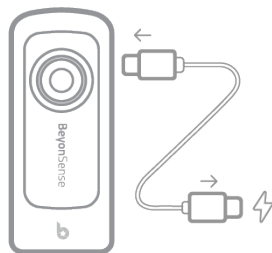

Use the provided charging cable to charge BeyonSense.



- **Charging:** Battery Indicator will blink.
- **Charging complete:** Battery Indicator will turn off.
- **When the battery is low:** Battery Indicator will turn on.

◆ Power

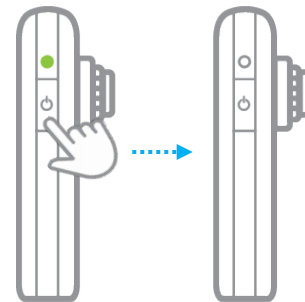
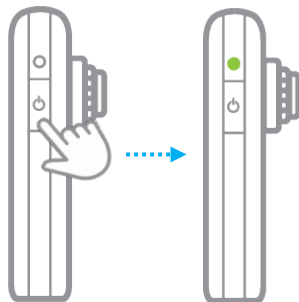

- **Power On:** Press the power button once.
- **Power Off:** Press and hold the power button.

◆ Replace lens

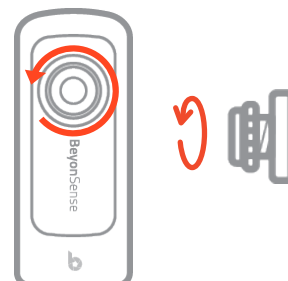
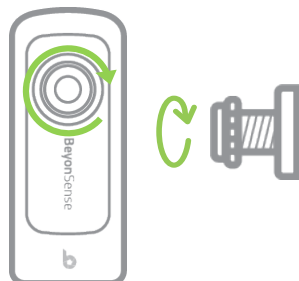

- **Mount:** Rotate clockwise to install.
- **Remove:** Rotate counterclockwise to disassemble.

Caution: When manipulating the IR Lens, its filter will be exposed. Do not touch or make contact with the filter as there is risk of permanent damage or breakage.



How to Use BeyonSense® Pre App (iOS & Android)

1. Install App

Download and install BeyonSense app on the phone/tablet.

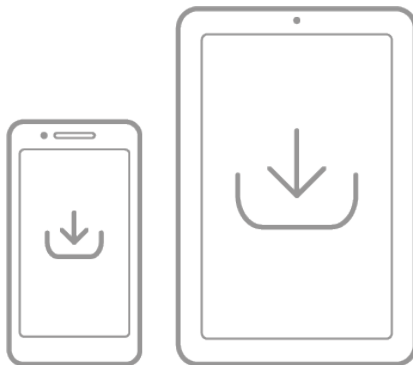

- **iOS:** [Apple Store Link](#)
App Store > Search > type 'BeyonSense' > Download latest version
- **Android:** [Google Play Store Link](#)
Google Play > Search > type 'BeyonSense' > Download latest version

2. Wi-Fi connection

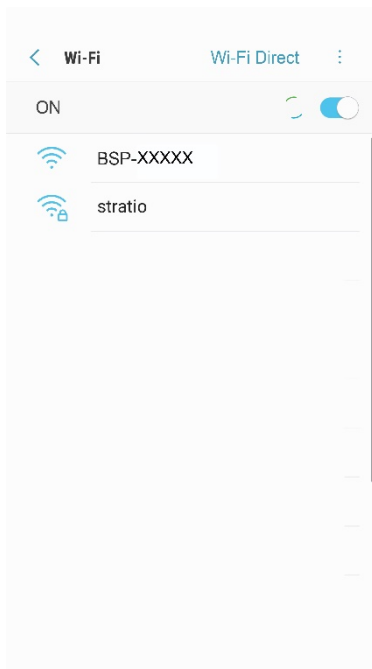

Please select "BSP-XXXXX" on the list to connect to BeyonSense via Wi-Fi.

3. Launch App

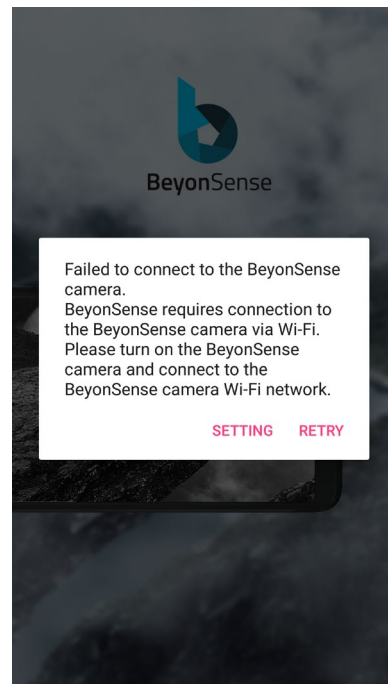

If BeyonSense isn't connected, this pop-up will warn you after the app is launched

SETTING: Go to Wi-Fi settings.

RETRY: Attempt to reconnect to BeyonSense device.



4. UI Description

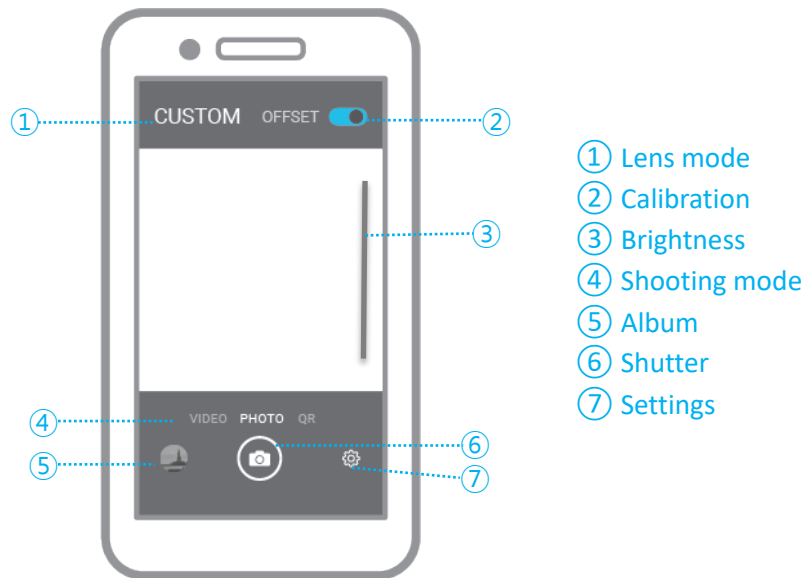

- ① Lens mode
- ② Calibration
- ③ Brightness
- ④ Shooting mode
- ⑤ Album
- ⑥ Shutter
- ⑦ Settings

① Lens mode

- **NORMAL:** For use with Normal Lens.
- **IR:** For use with IR Lens
- **CUSTOM:** For custom calibration use.

② Calibration

Calibration is only possible in "CUSTOM" mode.

- **OFFSET calibration:** to reduce noise and grain (dark current)

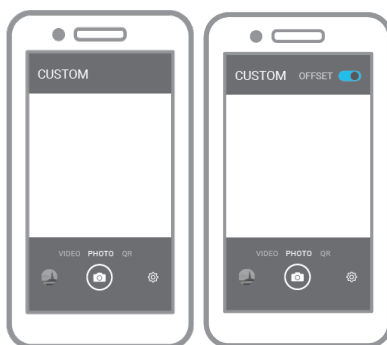

- 1) Cover the lens with the lens cap.
 - 2) Change the current mode to "CUSTOM".
 - 3) Tap the empty space next to "CUSTOM" to reveal OFFSET menu.
 - 4) Turn "OFFSET" on.
 - 5) Once the image brightness is totally still and stable, turn "OFFSET" off.
- * You shouldn't see any variation in brightness on the screen once OFFSET calibration is completed.

- **DYNAMIC RANGE calibration:** to set a minimum/maximum value of each pixel.

- 1) Cover the lens with the lens cap.
- 2) From the OFFSET calibration menu, tap OFFSET to reveal DYNAMIC RANGE. (OFFSET must be turned off to switch to DYNAMIC RANGE)
- 3) Turn DYNAMIC RANGE on.
- 4) Remove the Lens cap and point the lens at a white surface. (do NOT point the lens at a source of light)

* When the ambient light changes, you will need to repeat the DYNAMIC RANGE calibration process.



③ Brightness

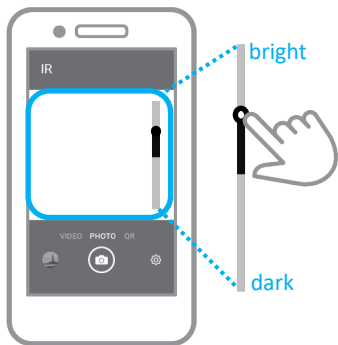

When you touch the screen, brightness control UI will be displayed. Adjust slider to control your desired brightness.

④ Screen mode

Swipe left or right to switch between VIDEO and PHOTO modes.



Recording timer will be displayed below the capture button.

⑤ Album

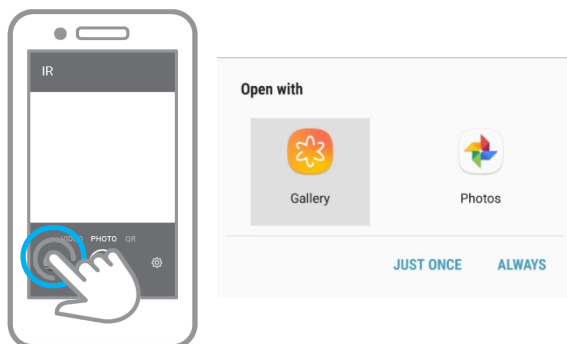

The thumbnail of captured images will be displayed on the bottom left of the screen. You can view captured photos and videos by tapping the thumbnail on the bottom left.



⑥ Shutter

The action performed by the button will change based on the shooting mode selected.



Mode name	VIDEO	PHOTO
Icon		
Function	Start/finish video recording	Take a picture

- Captured image will be saved to following path.

Android: emulated/0/BeyonSense.

iOS: saved in “Photos” application.

File name: yyyyymmddhhmmss (extension)

⑦ Settings

Basic app settings / versions, output options, camera version prompts, etc.

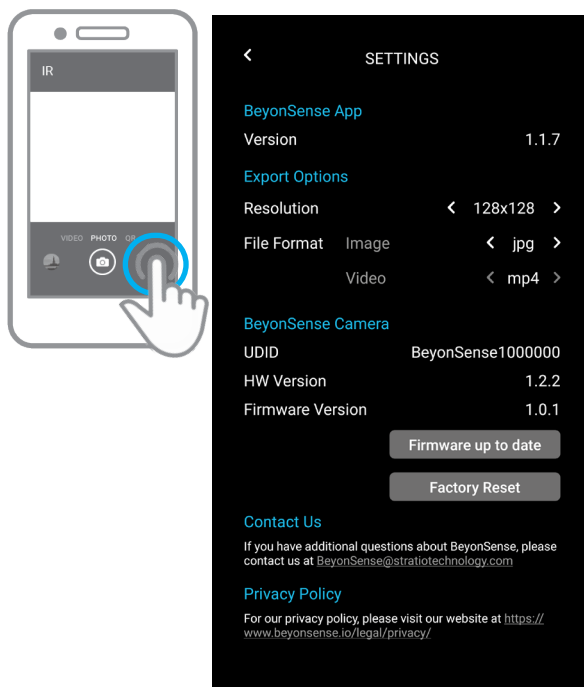

- **Version:** Current BeyonSense application’s version.
- **Resolution:** image resolution. (128/256/512)
- **File Format:** image file format. (jpg/png)
- **UDID:** device UDID.
- **HW Version:** Hardware version.
- **Firmware Version:** Firmware version.
- **Firmware up to date button:** Indicates if the firmware needs to be updated.
- **Factory reset button:** attempt to restore the BeyonSense device to original state.